

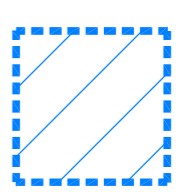















Notes

THIS DRAWING READ IN CONJUNCTION WITH :

-  DENOTES PROPOSED LICENSE BOUNDARY
-  DENOTES AREA OF RETAIL DISPLAYS WHERE ALCOHOL WILL BE SOLD FOR CONSUMPTION OFF PREMISES

FIRE LEGEND

BREAK GLASS UNIT	
SMOKE ALARM (O)- Optical (I)- Ionisation	
CARBON DIOXIDE ALARM	
CARBON MONOXIDE ALARM	
HEAT DETECTOR	
SMOKE DETECTOR / SOUNDER	
HEAT DETECTOR / SOUNDER	
HEAT DETECTOR / SOUNDER / BEACON	
SMOKE DETECTOR / SOUNDER / BEACON	
FIRE ALARM PANEL	
FIRE ALARM RESET PANEL	
FIRE ALARM POWER SUPPLY UNIT	
ILLUMINATED FIRE EXIT SIGNAGE	
SOUNDER / BEACON	
SOUNDER	

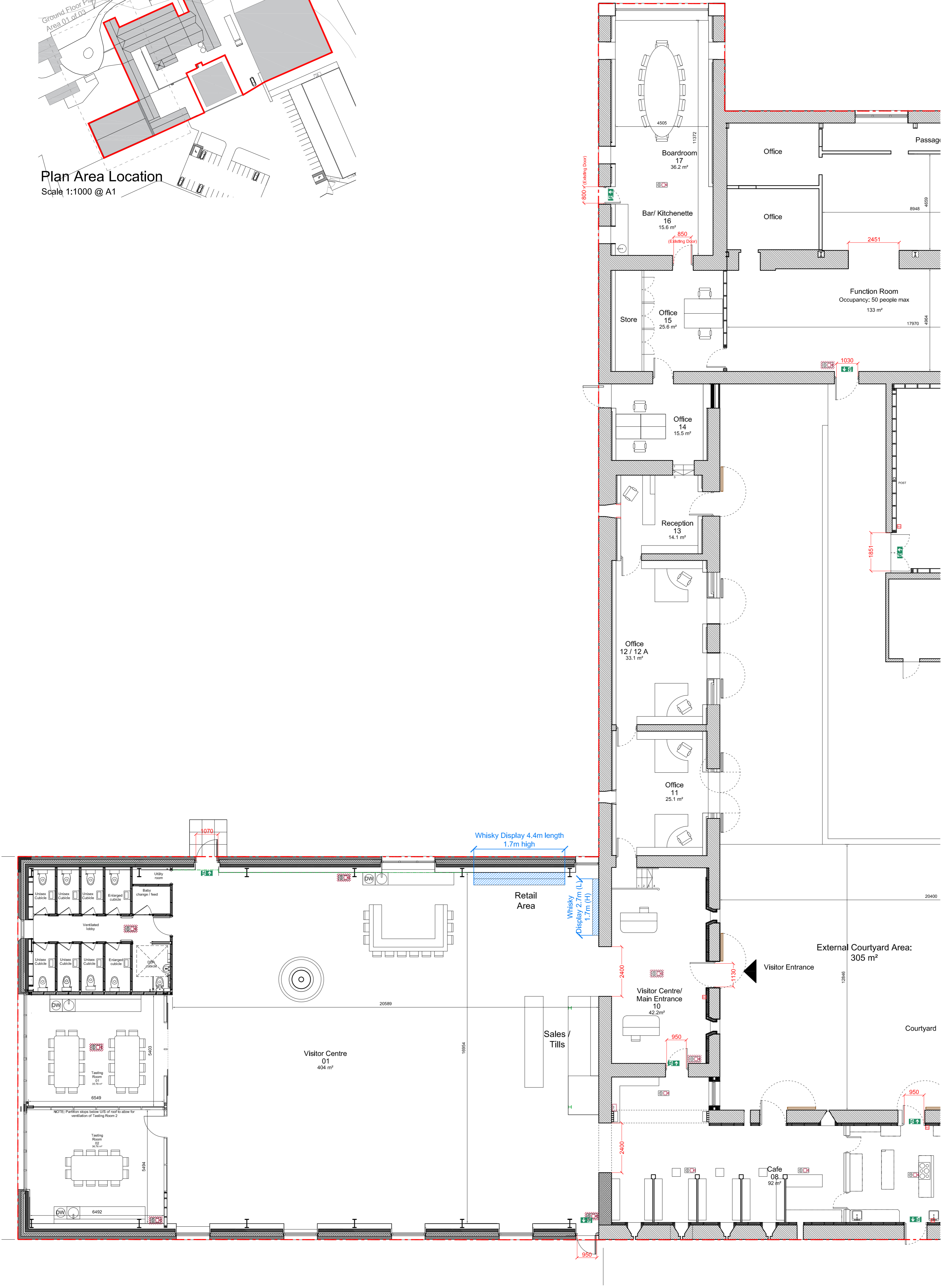
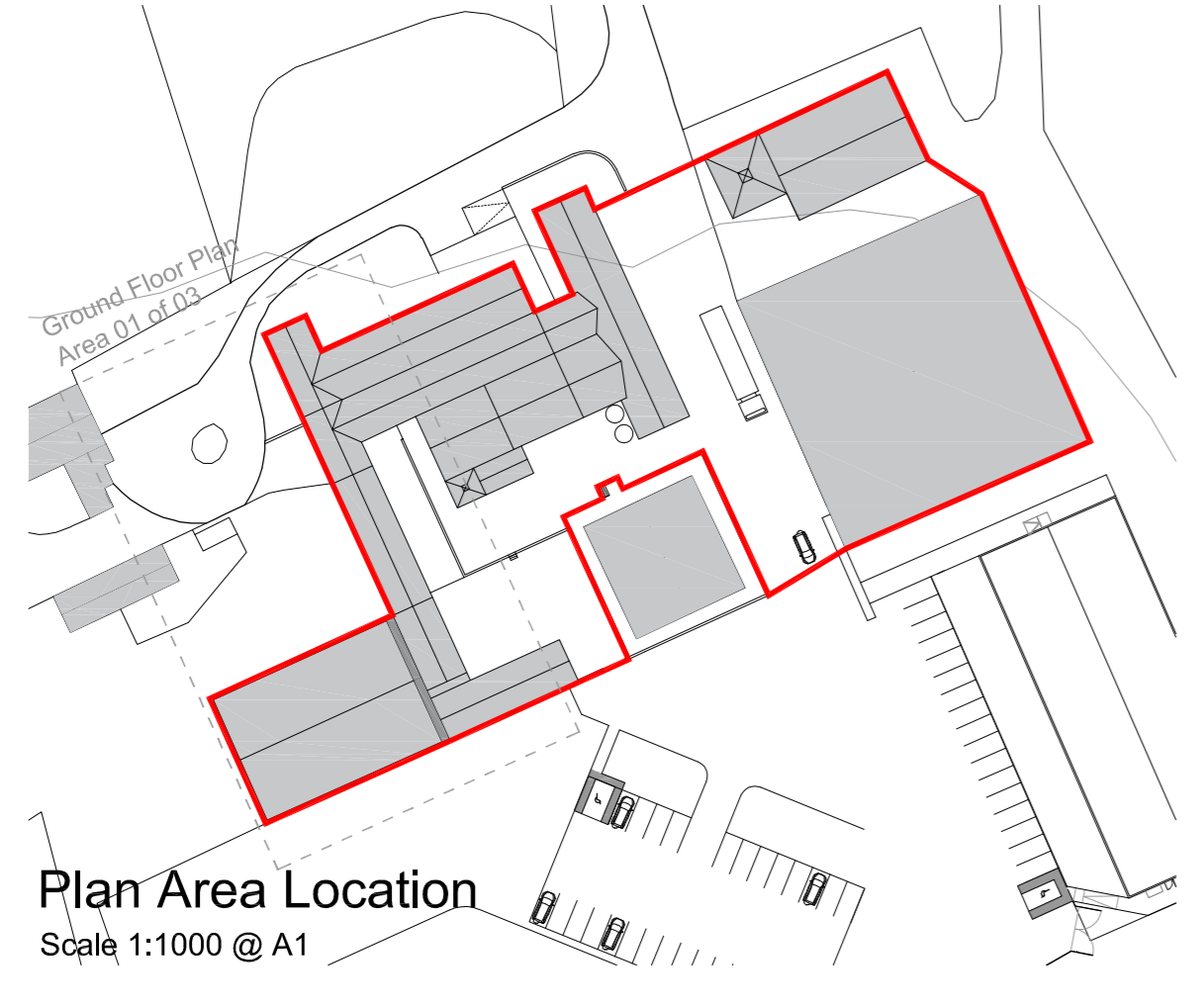

Issued for Licensing Information	06.02.20	RM	BMCA
Rev	Description	Date	Dr by / App by
RM		21.02.2020	



AMP Architects
83d Candleriggs
Glasgow
Scotland
G1 1LF
+44 141 345 2992
office@amparchitects.co.uk

Client The Kilchoman Distillery Company			
Project Kilchoman Distillery			
Drawing Licensing Layout Plan Ground Floor 01 of 03			
Project number 2017.00082.006	Scale 1:100	@A1	
Drawing number L(80)003	Rev -	Issue status LICENSE	
This drawing is to be read in conjunction with all related drawings. All dimensions must be checked and verified on site before commencing any work or producing shop drawings. The originator should be notified immediately of any discrepancy. This drawing is copyright and remains the property of AMP.			

Proposed Licence Layout Ground Floor Plan 01 of 03
Scale 1:100 @ A1